

# FC425

## Nylon abrasion sleeve

Meets MSHA requirements

Nylon sleeve protects hose from abrasion and allows bundling of hose lines.

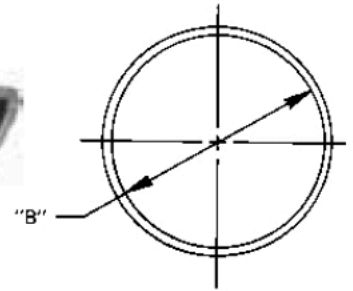

**For use with hose: see pages K-8-K-14**

Part number	Nominal Sleeve I.D.* "B"	
	mm	in.
FC425-12	18,0	0.71
FC425-16	25,4	1.00
FC425-18	28,7	1.13
FC425-20	31,7	1.25
FC425-24	40,4	1.59
FC425-28	44,4	1.75
FC425-32	52,6	2.07
FC425-38	60,4	2.38
FC425-40	64,5	2.54
FC425-46	72,6	2.86
FC425-54	84,8	3.34
FC425-59	93,0	3.66

\*The maximum O.D. of hose fittings must be allowed for if fittings are to be covered.